

Epping Forest District Council

Application to vary a premises licence under the Licensing Act 2003

PLEASE READ THE FOLLOWING INSTRUCTIONS FIRST

Before completing this form please read the guidance notes at the end of the form.
If you are completing this form by hand please write legibly in block capitals. In all cases ensure that your answers are inside the boxes and written in black ink. Use additional sheets if necessary.
You may wish to keep a copy of the completed form for your records.

I/We METRO Superstore being the premises licence holder, apply to vary a
(Insert name(s) of applicant)
premises licence under section 34 of the Licensing Act 2003 for the premises
described in Part 1 below

Premises licence number

LN/210005584

Part 1 – Premises details

Postal address of premises or, if none, ordnance survey map reference, or description	
785, CHIGWELL ROAD WOODFORD GREEN, ESSEX LONDON, UK	
Post town	Post code
CHIGWELL	IG8 8AU

Telephone number at premises (if any)

02085591117

Non-domestic rateable value of premises

£ 2110/

Part 2 – Applicant details

Daytime contact telephone number

02085592690

E-mail address
(optional)

metiosuperstore@yahoo.co.uk

Current postal
address if
different from
premises address

--

Post Town

--

Postcode

--

Part 3 - Variation

Do you want the proposed variation to have effect as soon as possible?

Please tick Yes

If not do you want the variation to take effect from

Day	Month	Year

If your proposed variation would mean that 5,000 or more people are expected to attend the premises at any one time, please state the number expected to attend

Please describe briefly the nature of the proposed variation (Please see guidance*note 1)

CONDITION TO BE REMOVED:
DPS MUST BE PRESENT AT ALL TIMES
WHEN ALCOHOL IS ON SALE
RESTRICTION PREVENTING SALE OF ALCOHOL
BETWEEN 4PM TO 7PM

Part 4 Operating Schedule

Please complete those parts of the Operating Schedule below which would be subject to change if this application to vary is successful.

Please tick yes

Provision of regulated entertainment

- a) plays (if ticking yes, fill in box A)
- b) films (if ticking yes, fill in box B)
- c) indoor sporting events (if ticking yes, fill in box C)
- d) boxing or wrestling entertainment (if ticking yes, fill in box D)
- e) live music (if ticking yes, fill in box E)
- f) recorded music (if ticking yes, fill in box F)
- g) performances of dance (if ticking yes, fill in box G)
- h) anything of a similar description to that falling within (e), (f) or (g)
(if ticking yes, fill in box H)

Provision of entertainment facilities for:

- i) making music (if ticking yes, fill in box I)
- j) dancing (if ticking yes, fill in box J)
- k) entertainment of a similar description to that falling within (i) or (j)
(if ticking yes, fill in box K)

Provision of late night refreshment (if ticking yes, fill in box L)

Sale by retail of alcohol (if ticking yes, fill in box M)

In all cases complete boxes N, O and P

A

Plays Standard days and timings (please read guidance note 6)			Will the performance of a play take place indoors or outdoors or both – please tick [Y] (please read guidance note 2)	Indoors	
Day	Start	Finish		Outdoors	
Mon			Please give further details here (please read guidance note 3)	Both	
Tue					
Wed			State any seasonal variations for performing plays (please read guidance note 4)		
Thur					
Fri			Non standard timings. Where you intend to use the premises for the performance of plays at different times to those listed in the column on the left, please list (please read guidance note 5)		
Sat					
Sun					

B

Films Standard days and timings (please read guidance note 6)			Will the exhibition of films take place indoors or outdoors or both – please tick [Y] (please read guidance note 2)	Indoors	
Day	Start	Finish		Outdoors	
Mon			Please give further details here (please read guidance note 3)	Both	
Tue					
Wed			State any seasonal variations for the exhibition of films (please read guidance note 4)		
Thur					
Fri			Non standard timings. Where you intend to use the premises for the exhibition of films at different times to those listed in the column on the left, please list (please read guidance note 5)		
Sat					
Sun					

C

Indoor sporting events Standard days and timings (please read guidance note 6)			<u>Please give further details (please read guidance note 3)</u>
Day	Start	Finish	
Mon			<u>State any seasonal variations for indoor sporting events (please read guidance note 4)</u>
Tue			
Wed			
Thur			<u>Non standard timings. Where you intend to use the premises for indoor sporting events at different times to those listed in the column on the left, please list (please read guidance note 5)</u>
Fri			
Sat			
Sun			

D

Boxing or wrestling entertainments Standard days and timings (please read guidance note 6)			<u>Will the boxing or wrestling entertainment take place indoors or outdoors or both – please tick [Y] (please read guidance note 2)</u>	Indoors	
Day	Start	Finish		Outdoors	
Mon			<u>Please give further details here (please read guidance note 3)</u>	Both	
Tue					
Wed					
Thur			<u>State any seasonal variations for boxing or wrestling entertainment (please read guidance note 4)</u>		
Fri					
Sat					
			<u>Non standard timings. Where you intend to use the premises for boxing or wrestling entertainment at different times to those listed in the column on the left, please list (please read guidance note 5)</u>		

Sun			
-----	--	--	--

E

Live music Standard days and timings (please read guidance note 6)			Will the performance of live music take place indoors or outdoors or both – please tick [Y] (please read guidance note 2)	Indoors		
Day	Start	Finish		Outdoors		
Mon			Please give further details here (please read guidance note 3)	Both		
Tue						
Wed				State any seasonal variations for the performance of live music (please read guidance note 4)		
Thur						
Fri				Non standard timings. Where you intend to use the premises for the performance of live music at different times to those listed in the column on the left, please list (please read guidance note 5)		
Sat						
Sun						

F

Recorded music Standard days and timings (please read guidance note 6)			Will the playing of recorded music take place indoors or outdoors or both – please tick [Y] (please read guidance note 2)	Indoors		
Day	Start	Finish		Outdoors		
Mon			Please give further details here (please read guidance note 3)	Both		
Tue						
Wed				State any seasonal variations for playing recorded music (please read guidance note 4)		
Thur						

Fri			Non standard timings. Where you intend to use the premises for the playing of recorded music entertainment at different times to those listed in the column on the left, please list (please read guidance note 5)
Sat			
Sun			

G

Performances of dance Standard days and timings (please read guidance note 6)			Will the performance of dance take place indoors or outdoors or both – please tick [Y] (please read guidance note 2)	Indoors	
				Outdoors	
				Both	
Day	Start	Finish			
Mon			Please give further details here (please read guidance note 3)		
Tue					
Wed			State any seasonal variations for the performance of dance (please read guidance note 4)		
Thur					
Fri			Non standard timings. Where you intend to use the premises for the performance of dance entertainment at different times to those listed in the column on the left, please list (please read guidance note 5)		
Sat					
Sun					

H

Anything of a similar description to that falling within (e), (f) or (g) Standard days and timings (please read guidance note 6)			Please give a description of the type of entertainment you will be providing		
Day	Start	Finish	Will this entertainment take place indoors or outdoors or both – please tick [Y] (please read guidance note 2)	Indoor	
				Outdoor	
				Both	
Mon					

Tue			Please give further details here (please read guidance note 3)
Wed			
Thur			State any seasonal variations for entertainment of a similar description to that falling within (e), (f) or (g) (please read guidance note 4)
Fri			
Sat			Non standard timings. Where you intend to use the premises for the entertainment of similar description to that falling within (e), (f) or (g) at different times to those listed in the column on the left, please list (please read guidance note 5)
Sun			

Provision of facilities for making music Standard days and timings (please read guidance note 6)			Please give a description of the facilities for making music you will be providing		
			Will the facilities for making music be indoors or outdoors or both – please tick [Y] (please read guidance note 2)	Indoors	
				Outdoors	
			Both		
Day	Start	Finish	Please give further details here (please read guidance note 3)		
Mon					
Tue			State any seasonal variations for the provision of facilities for making music (please read guidance note 4)		
Wed					
Thur			Non standard timings. Where you intend to use the premises for provision of facilities for making music entertainment at different times to those listed in the column on the left, please list (please read guidance note 5)		
Fri					
Sat					
Sun					

Provision of facilities for dancing Standard days and timings (please read guidance note 6)			Will the facilities for dancing be indoors or outdoors or both – please tick [Y] (see guidance note 2)	Indoors	
				Outdoors	
				Both	
Day	Start	Finish	Please give a description of the facilities for dancing you will be providing		
Moh			Please give further details here (please read guidance note 3)		
Tue					
Wed			State any seasonal variations for providing dancing facilities (please read guidance note 4)		
Thur					
Fri			Non standard timings. Where you intend to use the premises for the provision of facilities for dancing entertainment at different times to those listed in the column on the left, please list (please read guidance note 5)		
Sat					
Sun					

K

Provision of facilities for entertainment of a similar description to that falling within I or J Standard days and timings (please read guidance note 6)			Please give a description of the type of entertainment facility you will be providing		
Day	Start	Finish	Will the entertainment facility be indoors or outdoors or both – please tick [Y] (please read guidance note 2)	Indoor	
				Outdoor	
				Both	
Mon					

Tue			Please give further details here (please read guidance note 3)
Wed			
Thur			
Fri			State any seasonal variations for the provision of facilities for entertainment of a similar description to that falling within I or J (please read guidance note 4)
Sat			
Sun			Non standard timings. Where you intend to use the premises for the provision of facilities for entertainment of a similar description to that falling within I or J at different times to those listed in the column on the left, please list (please read guidance note 5)

L

Late night refreshment Standard days and timings (please read guidance note 6)			Will the provision of late night refreshment take place indoors or outdoors or both – please tick [Y] (please read guidance note 2)	Indoors	
Day	Start	Finish		Outdoors	
Mon			Please give further details here (please read guidance note 3)		
Tue					
Wed					
Thur			State any seasonal variations for the provision of late night refreshment (please read guidance note 4)		
Fri					
Sat			Non standard timings. Where you intend to use the premises for the provision of late night refreshment at different times, to those listed in the column on the left, please list (please read guidance note 5)		
Sun					

M

Supply of alcohol Standard days and timings (please read guidance note 6)			Will the sale of alcohol be for consumption (Please tick box Y) (please read guidance note 7)	On the premises				
				Off the premises	<input checked="" type="checkbox"/>			
Day	Start	Finish	Both					
Mon	8:00	23:00	State any seasonal variations for the supply of alcohol (please read guidance note 4)					
Tue	8:00	23:00						
Wed	8:00	23:00						
Thur	8:00	23:00				Non-standard timings. Where you intend to use the premises for the supply of alcohol at different times to those listed in the column on the left, please list (please read guidance note 5)		
Fri	8:00	23:00						
Sat	8:00	23:00						
Sun	8:00	23:00						

N

Please highlight any adult entertainment or services, activities, other entertainment or matters ancillary to the use of the premises that may give rise to concern in respect of children (please read guidance note 8)

N/A

O

Hours premises are open to the public Standard days and timings (please read guidance note 6)			State any seasonal variations (please read guidance note 4)		
Day	Start	Finish			
Mon	8:00	23:00			
Tue	8:00	23:00			

Wed	8:00	23:00	Non standard timings. Where you intend to use the premises to be open to the public at different times from those listed in the column on the left, please list (please read guidance note 5)
Thur	8:00	23:00	
Fri	8:00	23:00	
Sat	8:00	23:00	
Sun	8:00	23:00	

Please identify those conditions currently imposed on the licence which you believe could be removed as a consequence of the proposed variation you are seeking

CONDITIONS TO BE REMOVED:
 DPS MUST BE PRESENT AT ALL TIMES WHEN ALCOHOL IS ON SALE.
 RESTRICTION PREVENTING SALE OF ALCOHOL BETWEEN 4PM TO 7PM.

- I have enclosed the premises licence Please tick ✓ yes
- I have enclosed the relevant part of the premises licence If you have not ticked one of these boxes please fill in reasons for not including the licence, or part of it, below

Reasons why I have failed to enclose the premises licence or relevant part of premises licence

N/A

P

Describe any additional steps you intend to take to promote the four licensing objectives as a result of the proposed variation:

a) General – all four licensing objectives (b,c,d,e) (please read guidance note 9)

WE WILL TAKE ALL THE NECESSARY STEPS.
PREMISES IS EQUIPED WITH CCTV MONITORING AND ALL STAFF HAVE FULL TRAINING AND UNDERSTANDING OF THE RULES, RESPONSIBILITIES AND FUNCTIONS OF THE LICENSING OBJECTIVES.

b) The prevention of crime and disorder

THE PREMISES HAS CCTV MONITORING.
WE DO NOT SALE ALCOHOL TO DRUNK PEOPLE AND UNDERAGE PERSON.

c) Public safety

WE ENSURE PUBLIC SAFETY THROUGH CCTV MONITORING AND HAVE PROPER LIGHTING INSIDE AND OUTSIDE THE SHOP.

d) The prevention of public nuisance

WE WILL NOT PLAY ANY LOUD MUSIC IN THE SHOP. WE WILL NOT SERVE ANY DRUNK PERSONS NOR ENCOURAGE LOITERING IN OR DIRECTLY OUTSIDE THE SHOP. ALCOHOL WILL NOT BE ALLOWED TO BE CONSUMED IN THE PREMISES.

e) The protection of children from harm

WE HAVE RESTRICTION ON THE NUMBER OF SCHOOL CHILDREN ALLOWED IN THE SHOP AT ANYONE TIME UNLESS ACCOMPAINED BY AN ADULT. WE HAVE A STRICT ID POLICY FOR ANY PERSON LOOK UNDERAGE. ALCOHOL WILL BE STORED AND DISPLAYED SAFELY.

Please tick ✓ yes

- I have made or enclosed payment of the fee
- I have sent copies of this application and the plan to responsible authorities and others where applicable
- I understand that I must now advertise my application
- I have enclosed the premises licence or relevant part of it or explanation
- I understand that if I do not comply with the above requirements my application will be rejected

IT IS AN OFFENCE, LIABLE ON CONVICTION TO A FINE UP TO LEVEL 5 ON THE STANDARD SCALE, UNDER SECTION 158 OF THE LICENSING ACT 2003 TO MAKE A FALSE STATEMENT IN OR IN CONNECTION WITH THIS APPLICATION

Part 5 – Signatures (please read guidance note 10)

Signature of applicant (the current premises licence holder) or applicant's solicitor or other duly authorised agent (please read guidance note 11). If signing on behalf of the applicant please state in what capacity.

Signature

.....

Date..... 12/11/11 11/12/2011

Capacity

..... SUPERVISOR

Where the premises licence is jointly held signature of 2nd applicant (the current premises licence holder) or 2nd applicant's solicitor or other authorised agent (please read guidance note 12). If signing on behalf of the applicant please state in what capacity.

Signature

.....

Date.....

Capacity

.....

Contact name (where not previously given) and address for correspondence associated with this application (please read guidance note 13)	
Post town	Post code
Telephone number (if any)	
If you would prefer us to correspond with you by e-mail your e-mail address (optional)	

Notes for Guidance

This application cannot be used to vary the licence so as to extend the period for which the licence has effect or to vary substantially the premises to which it relates. If you wish to make that type of change to the premises licence you should make a new premises licence application under section 17 of the Licensing Act 2003.

Notes for Guidance

1. Describe the premises. For example the type of premises, its general situation and layout and any other information which could be relevant to the licensing objectives. Where your application includes off-supplies of alcohol and you intend to provide a place for consumption of these off-supplies you must include a description of where the place will be and its proximity to the premises.
2. Where taking place in a building or other structure please tick as appropriate. Indoors may include a tent.
3. For example state type of activity to be authorised, if not already stated, and give relevant further details, for example (but not exclusively) whether or not music will be amplified or unamplified.
4. For example (but not exclusively), where the activity will occur on additional days during the summer months.
5. For example (but not exclusively), where you wish the activity to go on longer on a particular day e.g. Christmas Eve.
6. Please give timings in 24 hour clock (e.g. 16:00) and only give details for the days of the week when you intend the premises to be used for the activity.
7. If you wish people to be able to consume alcohol on the premises please tick on, if you wish people to be able to purchase alcohol to consume away from the premises please tick off. If you wish people to be able to do both please tick both.
8. Please give information about anything intended to occur at the premises or ancillary to the use of the premises which may give rise to concern in respect of children regardless of whether you intend children to have access to the premises, for example (but not exclusively) nudity or semi-nudity, films for restricted age groups, the presence of gaming machines.
9. Please list here steps you will take to promote all four licensing objectives together.
10. The application form must be signed.
11. An applicant's agent (for example solicitor) may sign the form on their behalf provided that they have actual authority to do so.
12. Where there is more than one applicant, both applicants or their respective agents must sign the application form.
13. This is the address which we shall use to correspond with you about this application.

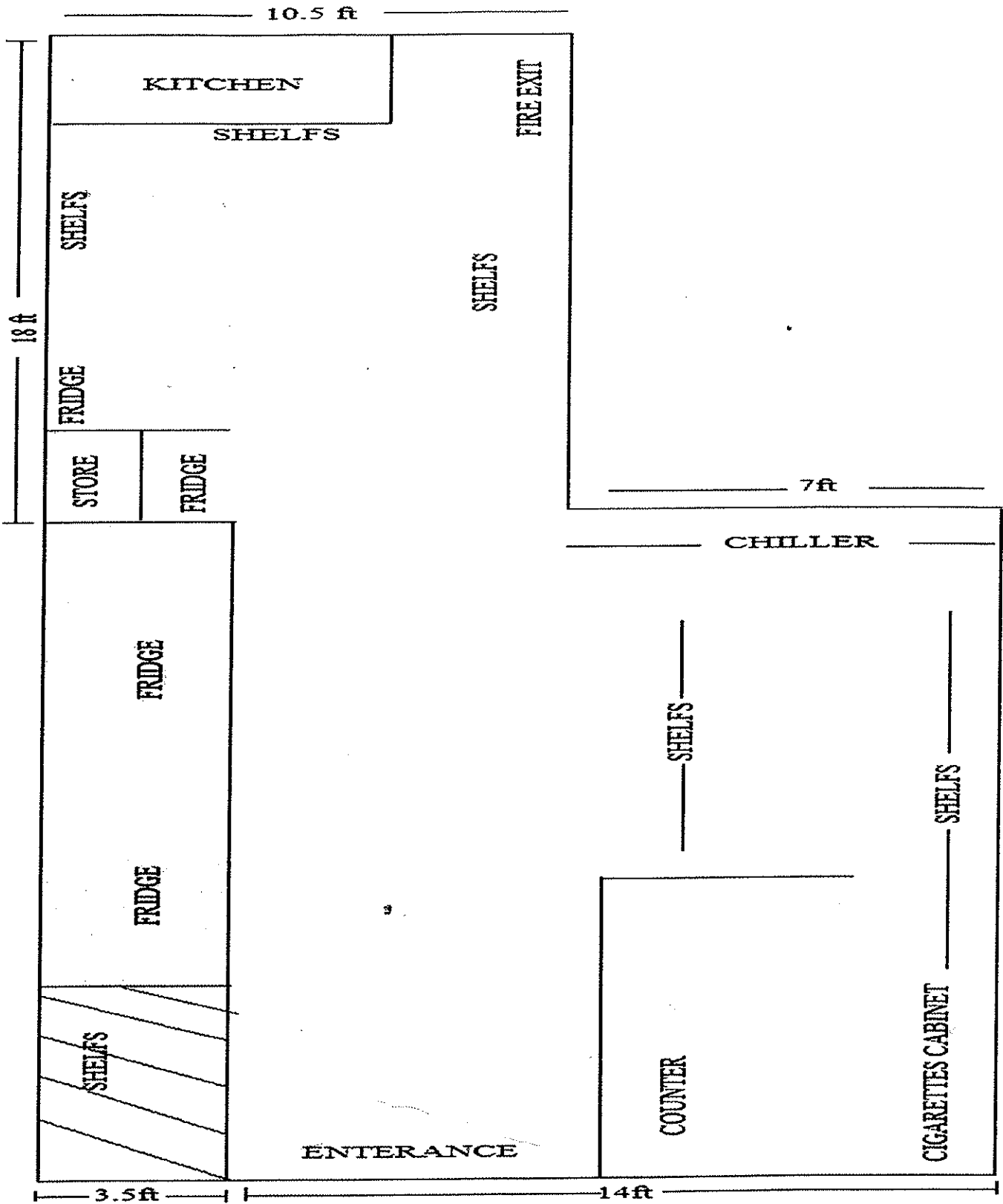

Ground Floor
785 Chigweel Road
Woodford Green
Essex IG8 8AU

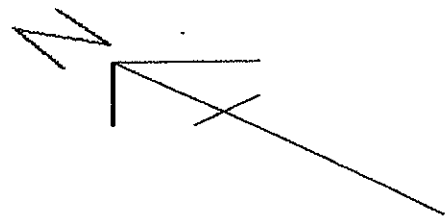

Agents:

NARTS Tel: 020 7241 3636

Email: info@act2003.com

**NOTICE OF APPLICATION FOR A VARIATION
PREMISES LICENCE UNDER THE LICENSING
ACT 2003**

Notice is given this day 13th December 2011 that METRO SUPERSTORE of Chigwell Road, Chigwell, Essex, IG8 8AU has applied to the licensing office of Epping Forest District Council for a premises licence in respect of 785 Chigwell Road, Chigwell, Essex, IG8 8AU. The proposed variation is for Sale Of Alcohol 08:00 to 23:00 Monday to Sunday. Conditions To Be Removed : DPS must be present at all times when alcohol is on sale. Restriction preventing sale of alcohol between 4: 00 pm to 7:00 pm. The register of licensed premises is maintained at the licensing office of Epping Forest District Council, Civic, Offices, High Street, Epping, Essex, CM16 4BZ. Applications for premises licenses may be inspected at this office during office hours. Anyone wishing to oppose this application must give written notice to the licensing office within 28 day of this notice. It is an offence knowingly or recklessly to make a false statement in connection with an application which could lead to a fine on summary conviction (maximum £5000).

Goods Vehicle Operator's Licence

Wah Gwaan Foods LTD trading as Yam-Man Imports of Unit 51 Leyton Industrial Village, Argall Trading Estate, Argall Avenue London E10 7PQ is applying for a licence to use Unit 51 Leyton Industrial Village, Argall Trading Estate, Argall Avenue London E10 7PQ as an operating centre for 2 goods vehicles. Owners or occupiers of land (including buildings) near the operating centre who



Licensing Department,
Harlow Police Station,
South Gate,
Harlow,
Essex CM20 1HG

Telephone 01279 625 405

Facsimile: 01279 625 476

Website: www.essex.police.uk

Email: Peter.Jones@essex.pnn.police.uk

Mrs Kim Tuckey
Licensing Department
Epping Forest District Council
Civic Offices
High Street
Epping
CM16 4BZ

21st December 2011

Dear Kim,

LICENSING ACT 2003 – PREMISE LICENCE VARIATION S.34

PREMISE: Metro Superstore, 785 Chigwell Road

APPLICANT: Metro Superstore Ltd

DPS: Mr Rana Anwer

Further to the Variation received on 19th December 2011, I write to inform you that Essex Police will be making representations under Crime and Disorder to this variation for the following reasons:

In September 2010 a review hearing was held, and conditions were imposed that the applicant now wishes to be removed. Since this date crime and disorder, along with underage drinking has decreased in the area.

Essex Police believe that if the application were to be approved the likely effect would be the undermining of the crime and disorder licensing objective.

By removing the condition whereby alcohol sales between 1600 and 1900 are not permitted there will be an increase in the likelihood of minors attempting to purchase alcohol. Likewise by increasing the hours of licensable activity from 0800 will also increase the likelihood of minors attempting to purchase alcohol.

Essex Police will not support the removal of the condition relating to the Designated Premises Supervisor being present when alcohol is available for sale; but would support an amendment to a Personal Licence Holder being present when alcohol is available for sale.

Please advise me of when the Licensing Panel will be meeting to hear this so I can be in attendance.

**taking a lead in
making Essex safer**

www.essex.police.uk

Yours sincerely,

Peter Jones
Divisional Licensing Officer – Epping Forest District
Western Division

Cc. Metro Superstores Ltd – Applicant

Kevin Phelan
— Chigwell Road
Chigwell
Essex
IG8 8AU

06-01-2012

Licensing section
Epping Forest District Council
Civic Offices
High Street
Epping
CM16 4BZ

Dear Sirs,

Metro superstore, 785 Chigwell road, Chigwell, Essex, IG8 8AU

Application to reinstate license restrictions.

I write to you with great concerns regarding the above situation. Myself and my business partners of the restaurant next door to the metro store feel strongly against reinstating this licence, We as well as many other residents on Smeaton road have seen the effects caused by allowing these people to sell alcohol. I'm sure you have heard from others that since loosing their license things have pretty much been peaceful in this area, I am 100% sure that if you give them back this license things will slip back to the way they were before if not they will be worse, I suggest just looking at police reports alone just to give you an idea, this shop IS the source to all the trouble.

Police did do everything in their power to restore order before and it took what seemed forever, we more than anyone suffered, criminal damage, verbal abuse, assault, indecent behaviour, business loss, and even money loss due to extra protection surrounding the building!

I urge you to consider not allowing this license to be approved, I know for a fact that locals will only suffer for it. I read an article the guardian published on this matter and the shop owner is quoted saying "there's a demand for alcohol sales" this is rubbish because anyone that lives close to this shop will say different! Another concern of mine is that the locals are not well informed of this application being applied for, the fact that they only have to show a A4 blue letter in their shop window is not enough, I'm fortunate enough to have had a neighbour notify me if not I would not know they reapplied!

West Hatch school is even against this shop, they are effected on a daily basis with complaints of their students causing problems, it reflects bad on pretty much what was the perfect and quiet area this once was. I know residents that have lived here for more that 30 years and have even said they wish to move away because of these problems, why should they??

Please do take all this in to consideration as I'm sure this will cause you less headache in the future.

Kind regards

K.Phelan

Lisa Wilkes
Smeaton Road
Chigwell
Essex
IG8 8BD

Licensing Section
Epping Forest District Council
Civic Offices
High Street
Epping
CM16 4BZ

20 December 2011

Dear Sirs

Metro Superstore, 785 Chigwell Road, Woodford Green IG8 8AU
Application to reinstate license restrictions

I understand from the Guardian newspaper that this store is applying to have their license restrictions lifted, which currently means they are not able to sell alcohol between 4pm and 7pm.

This was put in place due to them consistently selling alcohol to children that in turn led to an epidemic of anti-social behaviour in Smeaton Road, which had previously been a quiet and peaceful road prior to the opening of this store.

As a home owner who lives very close to the store, I am happy to report that these restrictions, combined with the efforts of Essex Police, have worked very well and consequently there has been no trouble in Smeaton Road for many months.

I am extremely concerned that if the current ban is lifted or relaxed, then the students of West Hatch and other youths under the age of 18, will again congregate in Smeaton Road after school and into the evening and once again there will be anti-social behaviour.

I cannot begin to emphasise the affect that the prolonged anti-social behaviour had on me and other local residents and businesses. It became so bad that I tried to sell my house, but was unable to because of the bad reputation of Smeaton Road.

I believe that the current restrictions are working and are an appropriate and fair compromise that allows for both the residents to live in a peaceful environment and for the Metro to continue with their business, and I therefore urge you to please consider leaving the restriction in place.

Yours faithfully



Miss Lisa M Wilkes
Tel:
Email:

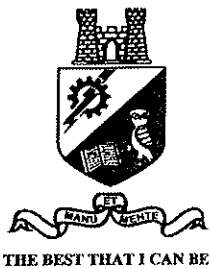

West Hatch High School

A Specialist Business and Enterprise School

Headteacher: Mrs F A Howarth M.A.

High Road, Chigwell, Essex, IG7 5BT

Tel: 020 8504 8216
Fax: 020 8559 2695

Email: admin@westhatch.essex.sch.uk
Website: www.westhatch.essex.sch.uk

9th January 2012

Ms N Glasscock
Licensing Section
Corporate Support Services
Epping Forest District Council
Civil Offices
High Street
Epping
CM16 4BZ

Dear Nicki

I write to strongly oppose the proposed extension to licensing hours at the Metro on the High Street close to West Hatch High School, Chigwell.

Following a period of antisocial behaviour when alcohol restrictions were less rigorous, we have enjoyed, as have the residents, a period of calm and much improved behaviour. I am very concerned that the proposed extension will undo all the good work that has been done.

Yours sincerely

F A Howarth (Mrs)
Headteacher



PREMISES LICENCE

Part A



Premises licence number:

LN/210005584

Part 1 – Premises details:

Postal address of premises, or if none, ordnance survey map reference or description:

Metro Superstore,
785 Chigwell Road

Post Town: Chigwell

Post code: IG8 8AU

Telephone number: 0208 559 1117

Where the licence is time limited the dates: N/A

Licensable activities authorised by the licence:
Supply of Alcohol

The times the licence authorises the carrying out of licensable activities:
Monday – Sunday – 10:00am – 16:00pm
19:00pm – 22:00pm

The opening hours of the premises:
Monday – Saturday – 07:00am – 23:00pm
Sunday – 09:00am – 22:00pm

Where the licence authorises supplies of alcohol whether these are on and / or off supplies: Off

Name, (registered) address, telephone number and e-mail (where relevant) of holder of premises licence:

Metro Superstore Ltd
785 Chigwell Road
Chigwell
Essex
IG8 8AU
0208 559 1117
metrosuperstore@yahoo.co.uk

Registered number of holder, for example company number, charity number (where applicable):
07130772

Name, address and telephone number of designated premises supervisor where the premises licence authorises the supply of alcohol:

Rana Fida Anwer

Personal licence number and issuing authority of personal licence held by designated premises supervisor where the premises licence authorises for the supply of alcohol:

674285

Southend on Sea Borough Council

Annex 1 – Mandatory conditions:

1. No supply of alcohol may be made under the premises licence:-
 - a) at a time when there is no designated premises supervisor in respect of the premises licence, or
 - b) at a time when the designated premises supervisor does not hold a personal licence or when the designated supervisor has a licence suspended
2. Every supply of alcohol under the premises licence must be made or authorised by a person who holds a personal licence (see section 19 Licensing Act 2003)
3. Where a condition applies requiring a person to carry out a security activity at the premises, those individuals must be licensed by the Security Industry Authority (see section 21 Licensing Act 2003)
4. Where a premises licence authorises the exhibition of films, the admission of children to the exhibition of any film is to be restricted in accordance with section 20 Licensing Act 2003.

Conditions 5, 7,6 and 9 do not apply to premises licences where it authorises only the sale by retail off the premises.

5.—(1) The responsible person shall take all reasonable steps to ensure that staff on relevant premises do not carry out, arrange or participate in any irresponsible promotions in relation to the premises.

(2) In this paragraph, an irresponsible promotion means any one or more of the following activities, or substantially similar activities, carried on for the purpose of encouraging the sale or supply of alcohol for consumption on the premises in a manner which carries a significant risk of leading or contributing to crime and disorder, prejudice to public safety, public nuisance, or harm to children—

(a) games or other activities which require or encourage, or are designed to require or encourage, individuals to—

- (i) drink a quantity of alcohol within a time limit (other than to drink alcohol sold or supplied on the premises before the cessation of the period in which the responsible person is authorised to sell or supply alcohol), or
- (ii) drink as much alcohol as possible (whether within a time limit or otherwise);

(b) provision of unlimited or unspecified quantities of alcohol free or for a fixed or discounted fee to the public or to a group defined by a particular characteristic (other than any promotion or discount available to an individual in respect of alcohol for consumption at a table meal, as defined in section 159 of the Act);

(c) provision of free or discounted alcohol or any other thing as a prize to encourage or reward the purchase and consumption of alcohol over a period of 24 hours or less;

(d) provision of free or discounted alcohol in relation to the viewing on the premises of a sporting event, where that provision is dependent on—

- (i) the outcome of a race, competition or other event or process, or

(ii) the likelihood of anything occurring or not occurring;
(e) selling or supplying alcohol in association with promotional posters or flyers on, or in the vicinity of, the premises which can reasonably be considered to condone, encourage or glamorise anti-social behaviour or to refer to the effects of drunkenness in any favourable manner.

6. The responsible person shall ensure that no alcohol is dispensed directly by one person into the mouth of another (other than where that other person is unable to drink without assistance by reason of a disability).

7. The responsible person shall ensure that free tap water is provided on request to customers where it is reasonably available.

8.—(1) The premises licence holder or club premises certificate holder shall ensure that an age verification policy applies to the premises in relation to the sale or supply of alcohol.

(2) The policy must require individuals who appear to the responsible person to be under 18 years of age (or such older age as may be specified in the policy) to produce on request, before being served alcohol, identification bearing their photograph, date of birth and a holographic mark.

9. The responsible person shall ensure that—

(a) where any of the following alcoholic drinks is sold or supplied for consumption on the premises (other than alcoholic drinks sold or supplied having been made up in advance ready for sale or supply in a securely closed container) it is available to customers in the following measures—

- (i) beer or cider: ½ pint;
- (ii) gin, rum, vodka or whisky: 25 ml or 35 ml; and
- (iii) still wine in a glass: 125 ml; and

(b) customers are made aware of the availability of these measures.

For the purposes of these conditions a responsible person is

- the holder of a premises licence in respect of the premises,
- the designated premises supervisor (if any) under such a licence, or
- (any individual aged 18 or over who is authorised for the purposes of this section by such a holder or supervisor,

Annex 2 – Conditions consistent with the Operating Schedule:

The Prevention of Crime and Disorder.

Staff are to undergo appropriate training from Trading Standards or any other accredited trainer, to be arranged by the Designated Premises Supervisor (DPS) as soon as possible.
Alcohol will not be sold to any person who appears to be intoxicated.

Public Safety

DPS to be on premises at all times when alcohol is on sale.
CCTV cameras inside and outside the premises of digital quality recording for 31 days and to be made available to Police, Local Authority & Trading Standards on demand.

Prevention of Public nuisance

A sign is to be displayed on the premises asking customers to leave the premises quietly.
A sign is to be displayed with a contact number for the DPS, enabling residents to make contact should they have a complaint.
A minimum of one bin, of a minimum size of 100 litres, with a properly fitted cover shall be provided for the purpose of receiving rubbish from customers. The receptacle shall be maintained in a clean condition and emptied on a regular basis, or the receptacle shall be constructed, maintained and located so that access to them by vermin is prevented and arrangements shall be made for the regular lawful disposal of their contents.

The Protection of children from harm

The 'Challenge 25' scheme has been adopted to ensure that alcohol will not be sold on the premises to those under the age of 18 years. Only approved proof of identification will be accepted which shows their photograph, their date of birth and a holographic mark; such as passport, photo driving licence and a pass accredited card.
Staff training for the implementation of the challenge 25 policy will be carried out regularly, training records will be kept for at least 12 months and compliance will be monitored within the store.
Details of any sale of alcohol that has been refused will be kept in refusals log book.

Annexe 3 – Conditions attached after a hearing by the licensing authority:

As agreed at hearing on 2nd November 2010:

Sale of alcohol from 10:00am – 16:00pm and from 19:00pm to 22:00pm.

No sale of alcohol between the hours of 16:00pm and 19:00pm

Signage is to be erected to display sale times of alcohol

Consumption of alcohol is to be off the premises only.

Annexe 4 – Plans:

Plans held at Epping Forest District Council